



Warning :

- Be sure to check all packing material carefully for small parts, which may have come loose inside the carton during shipment.
- To prevent possible scratches and damage, this furniture must be assembled on a soft surface such as a blanket or carpet.

Components and Hardware List

<p>Tipping Restraint Kit</p>  <p>(A) 1 pc.</p>	<p>Tool Required (Not provided) Phillips Screwdriver</p> 
---	---

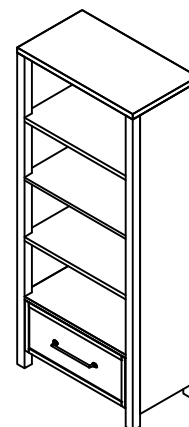

28637
Drawer Bookcase

The Rod is designed to accommodate Letter-size documents only.

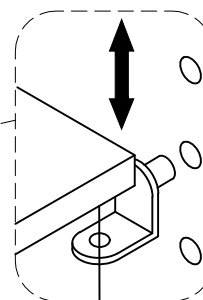
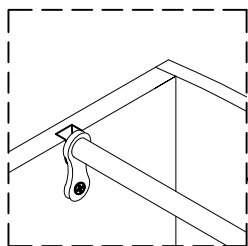

Unscrews to adjust
the shelf height.

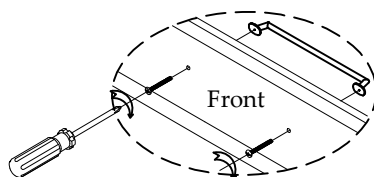

Remove Handle from inside drawer

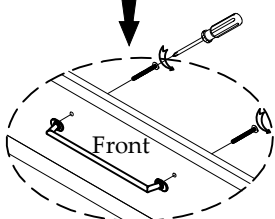

Reattach Handle to front of drawer

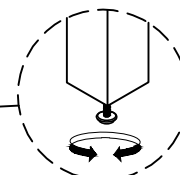

Adjustable leveler 4 pcs

- The File Drawers can be set up to use alone Letter size hanging file folders using the File Rods installed in the drawers.
- For product and personal safety, a Furniture Tipping Restraint kit has been included with this unit which can help to minimize the risk of the unit accidentally tipping forward, if used and properly installed per the manufacturer's instructions.